

All Points of the Compass

Friday, March 14th, 2025

For driving directions, registration information, and more, please visit: <http://tinyurl.com/CSUFGeography>

Parking Information

Parking Locations

Attending the symposium only?

The State College parking structure (SCPS, **blue square and arrow** on the upper map) on Gymnasium Dr. is the closest parking structure to the Titan Student Union (yellow star and arrow on the upper map), where the symposium will be held.

Enter the campus at Entrance #6 (from State College Blvd. onto Gymnasium Dr.) and turn into the parking structure.

Attending the symposium and the reception?

The Eastside South parking structure (ESPS, **green rectangle and arrow** on the upper map) on Folino Drive is the closest parking structure to the Humanities Building (**red rectangle and arrow** on the upper map), where the reception will be held.

Enter the campus at Entrance #1 (from Nutwood Ave. onto Folino Dr.) and park in the first parking structure.

Parking Costs

Attending the symposium?

Hourly permits (\$4 per hour) may be purchased using the ParkMobile app (a contactless option - hourly permits not available from permit machines). Hourly parking spaces are available on the ground level of the State College, Nutwood, and Eastside South parking structures.

Attending the symposium and the reception?

A daily permit may be purchased (\$12, through the [Guest Parking Portal](#) or the ParkMobile app - hourly permits not available from permit machines). Daily permits are valid in student lots and parking structures, unless restricted.

Note: If you are using the ParkMobile app, you will use a different "code" for hourly parking vs. daily parking.

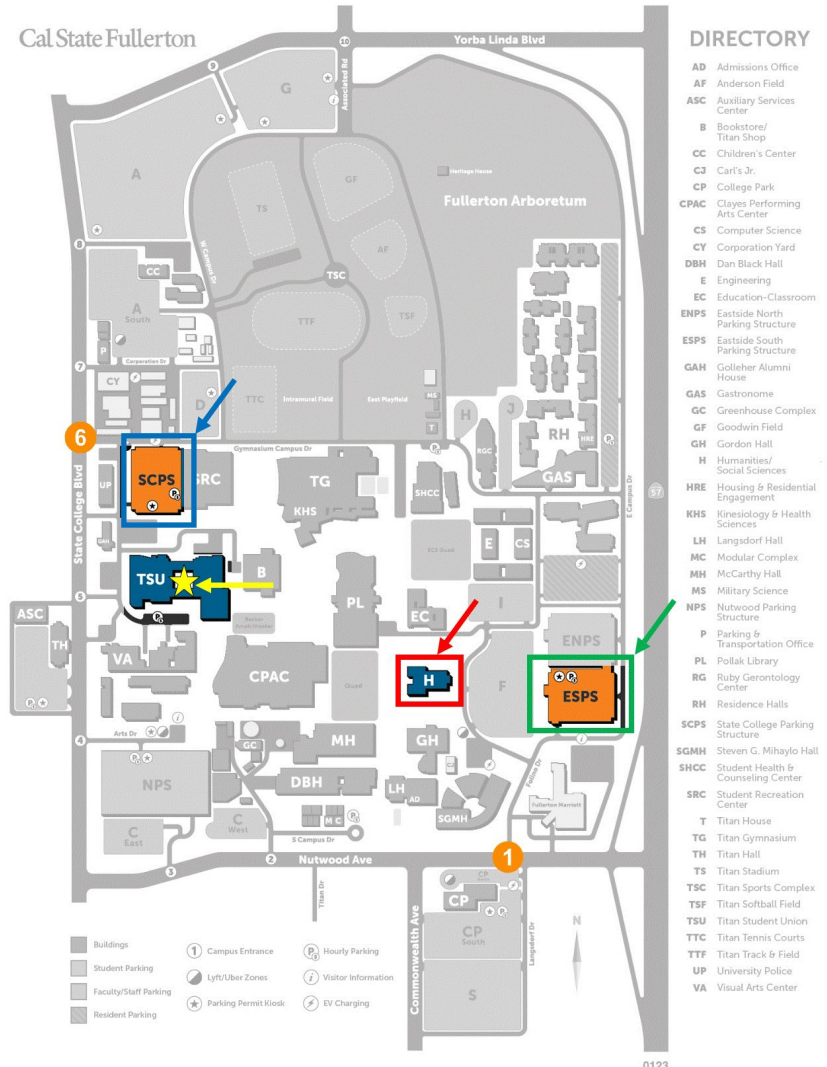

MAIN LEVEL

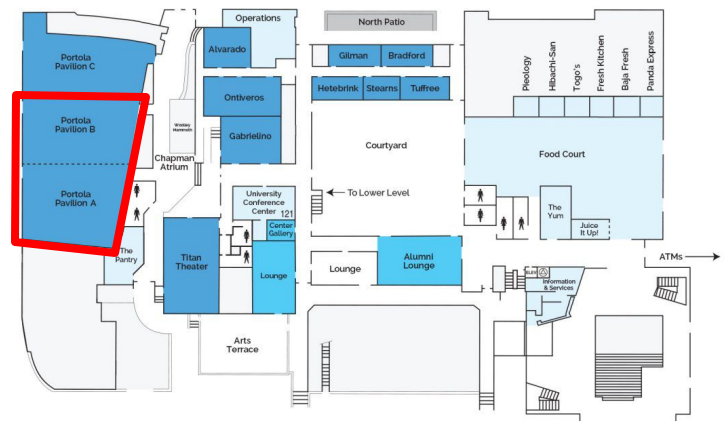

All Points of the Compass will be held in the CSUF Titan Student Union, in Pavilions A & B (on the main level - marked in red on the lower map)

All Points of the Compass

Friday, March 14th, 2025

For driving directions, registration information, and more, please visit: <http://tinyurl.com/CSUFGeography>

Parking Information

Parking Locations

- Attending the symposium only? The State College parking structure (SCPS, marked with a **blue square** on the upper map) on Gymnasium Dr. is the closest parking structure to the Titan Student Union (yellow star on the upper map), where the symposium will be held.

Enter the campus at Entrance #6 (from State College Blvd. onto Gymnasium Dr.) and turn into the parking structure.

- Attending the symposium and the reception? The Eastside South parking structure (ESPS, marked with a **green rectangle** on the upper map) on Folino Drive is the closest parking structure to the Humanities Building (**red rectangle** on the upper map), where the reception will be held.

Enter the campus at Entrance #1 (from Nutwood Ave. onto Folino Dr.) and park in the first parking structure.

Parking Costs

- Attending the symposium and the reception? A daily permit may be purchased (\$12, through the [Guest Parking Portal](#) or the ParkMobile app) Daily permits are valid in student lots and parking structures, unless restricted.

- Attending a portion of the symposium? Hourly permits (\$4 per hour) may be purchased using the ParkMobile app (a contactless option - hourly permits not available from daily permit machines). Hourly parking spaces are available on the ground level of the State College, Nutwood, and Eastside South parking structures.

Note: If you are using the ParkMobile app, you will use a different "code" for hourly vs. daily parking.



MAIN LEVEL

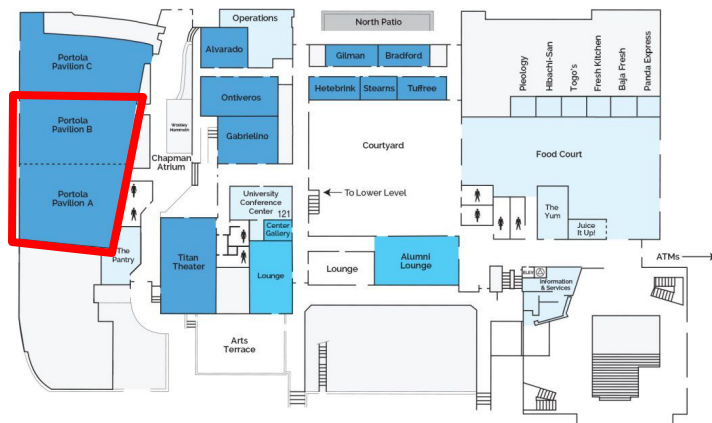

All Points of the Compass will be held in the CSUF Titan Student Union, in Pavilions A & B (on the main level - marked in red on the lower map)